

MKS09T08TWIN

EXTENDED SCISSOR DUAL ANTENNA POLE MOUNT (SCISSOR MOUNTING BRACKETS)

(A copy of these instructions to be included in each mounting kit box at manufacturer)

1. Attach two scissor mounting brackets 17 to outer mounting bracket 21 using M8 hardware 19 and tight to 15 ft-lbs (20 Nm).
2. Attach assembly created using previous step to both antennas scissor mounting brackets and secure using M8 bolt 22 and hardware. Tighten to 15 ft-lbs (20 Nm) (see detail D).
3. Assemble top mounting tilt bracket (see detail A).

1. Attach threaded rods 10 to pipe grip 2 with elevation using 1/2in. hardware and tighten 37 ft-lbs (50 Nm). (Ensure majority of threaded rod is remaining to attach rear pipe grip).

2. Use 1/4in. hardware through indexed scissor bracket 3 and long down tilt bracket 5 securing tilt at zero degrees (A indicator) tighten to 11 ft-lbs (15 Nm).
4. Attach top mount tilt bracket assembly to top outer mounting bracket 21 using 1/2in. hardware and tighten 37 ft-lbs (50 Nm).
5. Assemble mid & bottom mounting bracket (see detail B & C).

1. Attach threaded rods 10 to pipe grip 2 with elevation using 1/2in. hardware 37 ft-lbs (50 Nm). (Ensure majority of threaded rod is remaining to attach rear pipe grip.)

2. Mid bracket position should resemble top mount tilt bracket assembly at zero degrees.
6. Attach mid and bottom mount bracket assembly to mid and bottom outer mounting bracket 21 using 1/2in. hardware and tighten 37 ft-lbs (50 Nm).
7. Bring full assembly (antennas, outer mounting brackets, top, mid, and bottom bracket assemblies) to pole.
8. Using exposed threaded rod 10 attach rear mounting bracket 1 to pole using 1/2in. hardware and tighten to 37 ft-lbs (50 Nm).
9. Make all electrical connections and weatherproof with self- amalgamating tape.
- NOTE: Do NOT overtighten. Excessive torque loading will distort the pipe grip components.

ITEM NO.	PART NUMBER	DESCRIPTION	QTY
1	H04421	PIPE GRIP, REAR	3
2	H04422	PIPE GRIP WITH ELEVATION	3
3	H04423	INDEXED SCISSOR BRACKET	1
4	H04424	BRACKET, SHORT DOWNTILT	1
5	H04425	BRACKET, LONG DOWNTILT	1
6	H04426	DOWN TILT, ANGLE BRACKET	6
7	39800613	WASHER - LOCK GALV 1/2	32
8	37210012	WASHER - GALV 1/2	12
9	37310012	NUT-HHCS GALV 1/2	32
10	37410011	1/2-13 X 11 STUD, GALV.	6
11	37110112	BOLT 1/2-13 x 1-1/2in GALV	6
12	8500-352	SCREW, 1/2-13 X 1IN HHCS	14
13	660-017-1-003	SCREW, 1/4-20 X .75, HHCS (HEX)	2
14	660-017-1-004	NUT, 1/4-20, HEX NUT	2
15	660-017-1-002	WASHER, 1/4, SPLIT LOCK WASHER	2
16	H04480	MID SCISSOR BRACKET	1
17	3902773-68	SCISSOR MOUNTING BRACKET	6
18	6773500-68	M8 PLAIN WASHER GALV	42
19	5473130-68	M8 X 30mm Hex HD Screw Galv	24
20	6273400-68	M8 FULL NUT GALV	60
21	H04883	OUTER MOUNTING BRACKET	3
22	4473163-68	BOLT, M8 x 130mm	6
23	3801759/00	TILT SPACING BAR	6

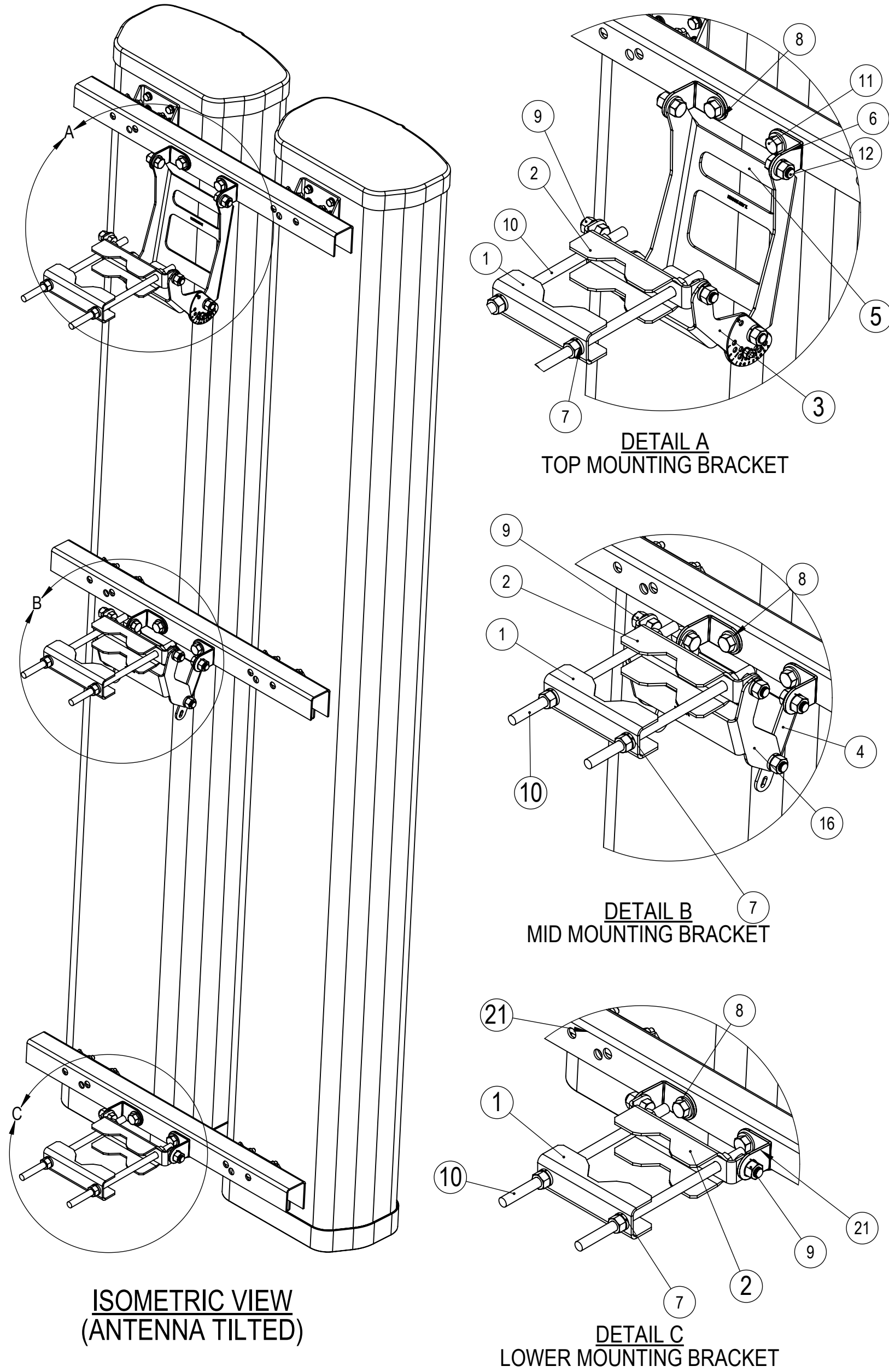
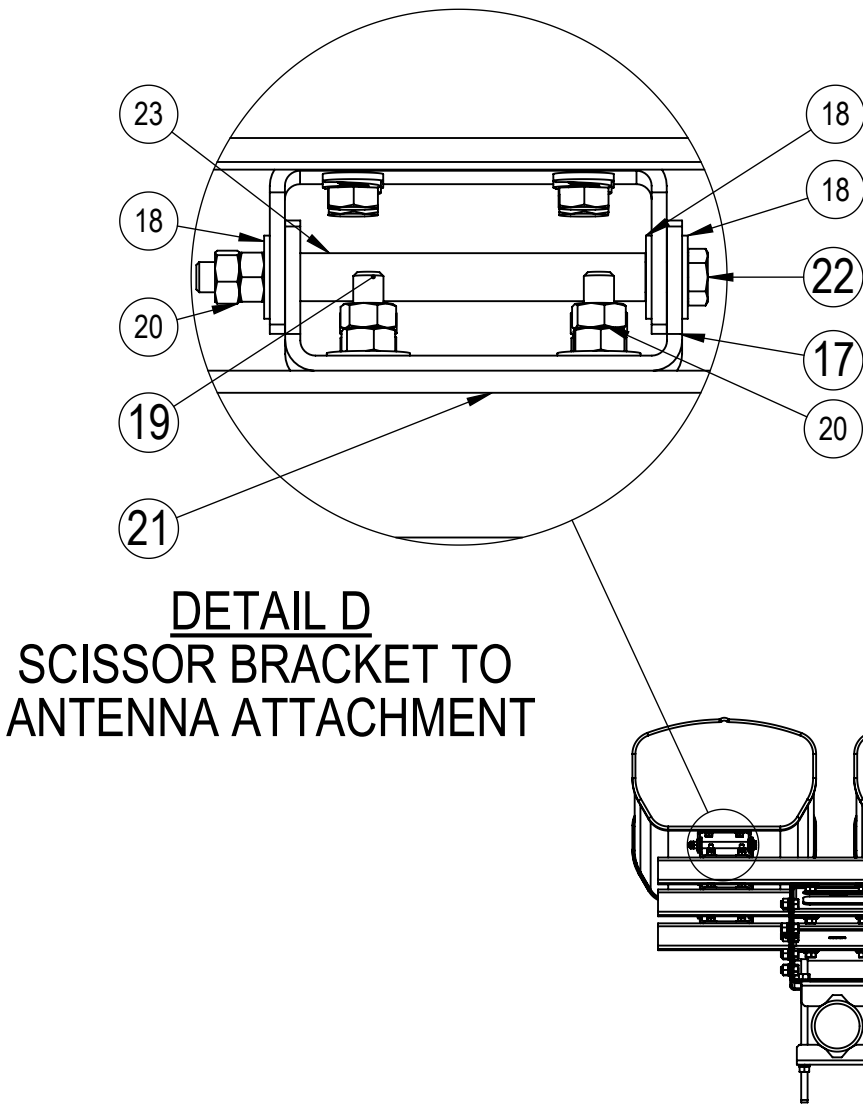

UNLESS OTHERWISE SPECIFIED  
DIMENSIONS ARE IN MILLIMETERS  
ANGULAR: ±1 0 PLACE: ±0.5  
1 PLACE: ±0.25 2 PLACE: ±0.15  
INTERPRET DIM AND TOL PER  
ASME Y14.5-2009

THIRD ANGLE PROJECTION

DO NOT SCALE  
DRAWING

NAME

DATE

DRAWN BY

1/13/2017

CHECKED BY

ENG APPR.

jsierzenga

12/21/2016

PROPRIETARY AND CONFIDENTIAL  
THE INFORMATION CONTAINED IN THIS  
DRAWING IS THE SOLE PROPERTY OF AMPHENOL  
ANTENNA SOLUTIONS. ANY REPRODUCTION IN  
PART OR AS A WHOLE WITHOUT THE WRITTEN  
PERMISSION OF AMPHENOL ANTENNA  
SOLUTIONS IS PROHIBITED.

TITLE:  
**MOUNTING KIT, WIDE EXTENDED SCISSOR,  
3 POINT, DUAL ANTENNAS**

SIZE  
**C**

DESIGNED USING  
**SOLIDWORKS**

DWG. NO.  
**MKS09T08TWIN**

REV  
**1**

1300 CAPITAL DRIVE  
ROCKFORD, IL 61109  
(815) 399-0001  
**www.amphenol-antennas.com**

SCALE: NONE | WEIGHT (Kg): 83.40 | SHEET 1 OF 1