

6184108

2-Band | 4-Port | FDD | Panel Antenna | X-Pol | 65° | Variable Tilt | 997 mm

- Dual band, 4-Port, X-Pol, variable tilt, panel antenna
- Independent tilt on each band 2-12°
- Manual (MET) or Remote (RET) electrical tilt options
- Mounting and downtilt brackets included

ACCESS PORT DESCRIPTION (CONNECTORS)		
This antenna has 4 colour-coded connectors located at the bottom face.		
Frequency Designation	P1	P2
Frequency Range	3300-3800 MHz	3300-3800 MHz
Polarisation	Xpol	Xpol
Horizontal Beamwidth	65°	65°
Electrical Downtilt Range	2-12°	2-12°
Connector Type	(2x) 4.3-10 Female	(2x) 4.3-10 Female

ORDERING OPTIONS

Select from the different options listed below

SELECT ELECTRICAL DOWNTILT CONTROL & AISG PROTOCOL	SELECT ACTUATOR	SELECT CONNECTOR TYPE	ANTENNA MODEL NUMBER
Manual Electrical Tilt (MET)	---	4.3-10 Female	6184108
Remote Electrical Tilt (RET) AISG v2.0 / 3GPP	Multi-Device Control Unit (MDCU)	4.3-10 Female	6184108G

ELECTRICAL CHARACTERISTICS		P1, P2	
Frequency Bands		3300-3800 MHz	
		3300-3590 MHz	3600-3800 MHz
Gain	At Mid Tilt	17.4 dBi	17.6 dBi
	Over All Tilts	17.2 ± 0.7 dBi	17.4 ± 0.7 dBi
Input Impedance		50Ω	
VSWR		< 1.5	
Polarisation		±45°	
Horizontal Beamwidth (-3 dB)		64° ± 5.2°	60° ± 5.5°
Vertical Beamwidth (-3 dB)		5.5° ± 0.9°	5.0° ± 0.8°
Electrical Downtilt Range		2-12° (continuously adjustable)	
Cross Polar Isolation		> 28 dB	
Port to Port Isolation		> 28 dB	
Interband Isolation		> 28 dB	
Upper Sidelobe Suppression	First Upper Lobe	> 15 dB	> 15 dB
	Peak to 20°	> 15 dB	> 15 dB
Front-to-Back Ratio (@ 180° ± 30°)		> 25 dB	
Cross Polar Ratio	Main Direction (0°)	> 15 dB	> 15 dB
	Sector Edges (±60°)	> 5 dB	> 5 dB
Maximum Power (Per Port)		200 W (at 50°C ambient temperature)	
Grounding		DC Ground	



A GLOBAL INITIATIVE



Standard values based on NGMN-P-BASTA version 10.0 recommendation.

Quoted performance parameters are provided to offer typical, peak or range values only and may vary as a result of normal testing, manufacturing and operational conditions. Extreme operational conditions and/or stress on structural supports is beyond our control. Such conditions may result in damage to this product. Improvements to products may be made without notice.

6184108

2-Band | 4-Port | FDD | Panel Antenna | X-Pol | 65° | Variable Tilt | 997 mm

INTEGRATED RET PROPERTIES	
Protocol	Compliant with 3GPP/AISGv2.0
Power Supply	10-30VDC
Adjustment Time (Full Range)	≤ 90 sec (typical, depending on antenna type)
Power Consumption	< 2 W (Idle); < 10 W (In Motion)
Accuracy	≤ 0.5°
Hardware Interface	RS485 And Power
Safety Standard	Compliant to EN 60950/UL 60950 / RoHS, CE
Remote control	OMC, BTS / NodeB
Adjustment Cycles	> 20,000
Torque Max	≥ 160 mN.m
Protection Class	IP65
Housing Material	Aluminum
Housing Color	Silvery white
Mounting	Directly onto Antenna
Lightning Protection Rating	IEC 61000-4-5 Current Pulse Profile, 8/20 μs 10 Repetitions Min. @ 8 kA
Connectors	2 x 8 Pins Connector According To IEC60130-9 AND AISG Daisy Chain In : Male, Daisy Chain Out : Female Pin3:RS485+; Pin5:RS485-; Pin6:10~30V; Pin7:GND Female connector: 8 PINs, Male connector: 5 PINs

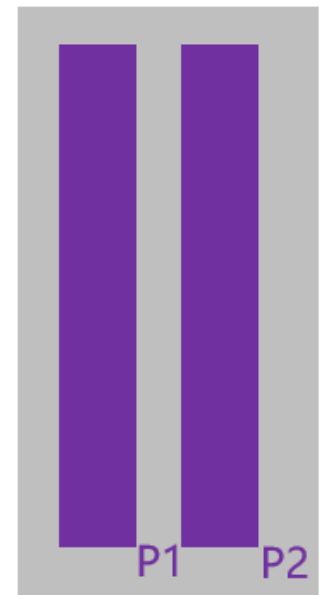
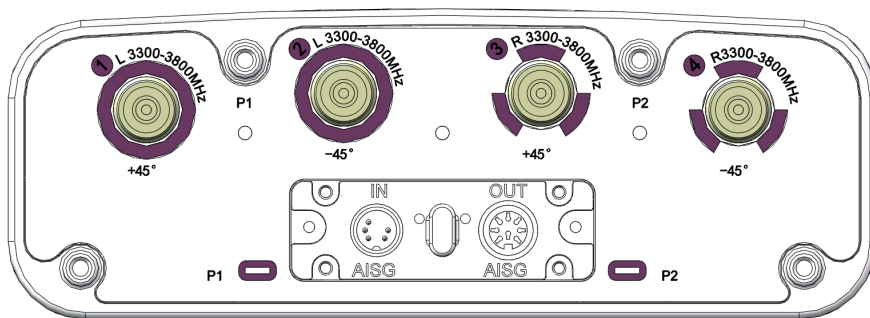

ARRAY LAY.	ARRAY	FREQUENCY	CONNECTOR	CONNECTOR TYPE
	P1	3300-3800	1-2	4.3-10 Female
	P2	3300-3800	3-4	4.3-10 Female

Diagram shown at right depicts the view from the front of the antenna. The illustration is not shown to scale.

Quoted performance parameters are provided to offer typical, peak or range values only and may vary as a result of normal testing, manufacturing and operational conditions. Extreme operational conditions and/or stress on structural supports is beyond our control. Such conditions may result in damage to this product. Improvements to products may be made without notice.

6184108

2-Band | 4-Port | FDD | Panel Antenna | X-Pol | 65° | Variable Tilt | 997 mm

MECHANICAL CHARACTERISTICS			PACKAGING	
Dimensions (Height x Width x Depth)	997 x 257 x 87 mm (39.2 x 10.1 x 3.4 in)		Carton Box 1.177 x 0.352 x 0.207 m (46.3 x 13.8 x 8.1 in)	
Weight (excluding mounting accessory)	9 kg (19.8 lbs)			
Weight with mounting accessory	13 kg (28.6 lbs)			
Radome Material	UPVC			
Maximum Wind Speed	200 km/h (124.3 mph)			
Wind Load at 150 km/h	Frontal	235 N (52.8 lbf)		
	Rear	265 N (59.5 lbf)		
	Lateral	100 N (22.4 lbf)		
MOUNTING KIT OPTIONS			POLE DIAMETER	MECHANICAL TILT
All mounting bracket kits are ordered separately unless otherwise indicated.				
Mounting and Downtilt Bracket Kit (Included)			Ø50-Ø125 mm (Ø2.0-Ø4.9 mm)	0-16°

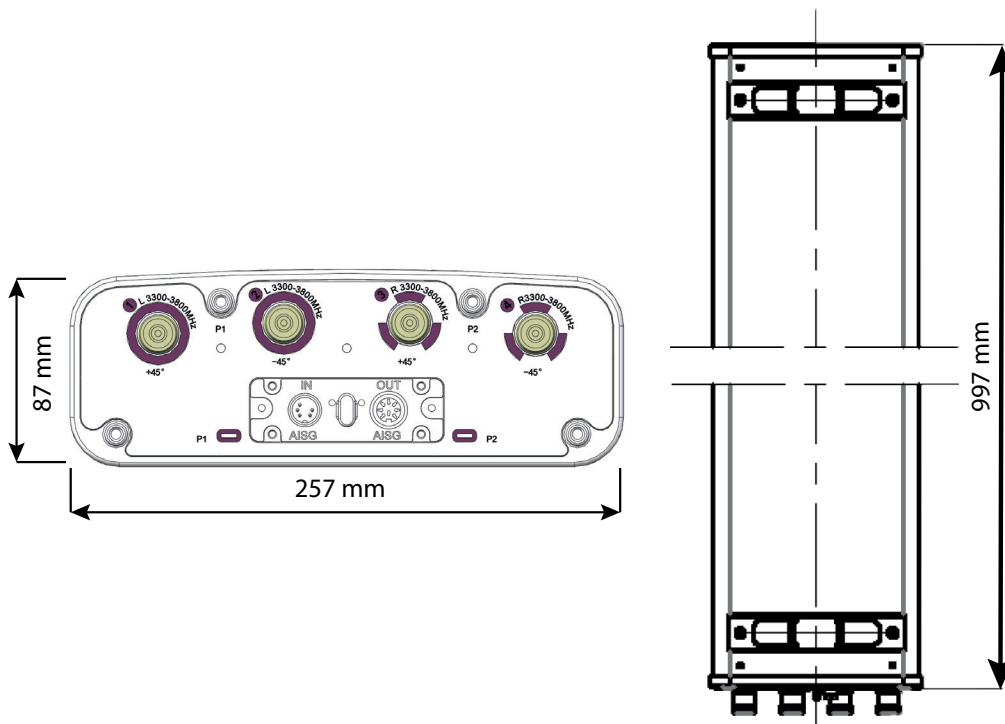

Quoted performance parameters are provided to offer typical, peak or range values only and may vary as a result of normal testing, manufacturing and operational conditions. Extreme operational conditions and/or stress on structural supports is beyond our control. Such conditions may result in damage to this product. Improvements to products may be made without notice.