

DC-xxHX-43F-CC

Directional Coupler | 698-3800 MHz | 4.3-10 Female

Ordering Options	DC-xxHX-43F-CC								
When ordering, replace the "xx" in the model number with the options listed below.									
Coupling Value (xx)	05	06	07	08	10	13	15	20	30
Electrical Characteristics									
Frequency Range	698-4000 MHz								
Coupling	5 dB	6 dB	7 dB	8 dB	10 dB	13 dB	15 dB	20 dB	30 dB
Coupling Deviation	±1.0 dB	±1.0 dB	±1.0 dB	±1.0 dB	±1.2 dB	±1.2 dB	±1.2 dB	±1.2 dB	±1.2 dB
Insertion Loss	≤ 2.3 dB	≤ 1.8 dB	≤ 1.5 dB	≤ 1.2 dB	≤ 1.1 dB	≤ 0.8 dB	≤ 0.7 dB	≤ 0.5 dB	≤ 0.3 dB
Isolation	≥ 25 dB	≥ 26 dB	≥ 27 dB	≥ 28 dB	≥ 30 dB	≥ 33 dB	≥ 35 dB	≥ 40 dB	≥ 45 dB
VSWR	≤ 1.30								
Average Power (max)	300 W								
Peak Power (max)	1000 W								
PIM3 (2x43 dBm)	≤ -160 dBc								
Impedance	50Ω								
Mechanical Characteristics									
Dimensions without Connector	122 x 48 x 36 mm								
Weight	0.68 kg								
Connector	4.3-10 Female								
Environmental Characteristics									
Operating Temperature	-35° C to +75° C								
Operating Humidity	Up to 100%								
Operating Air Pressure	70-106 kPa								
Application	Indoor / Outdoor								
Ingress Protection	IP65								

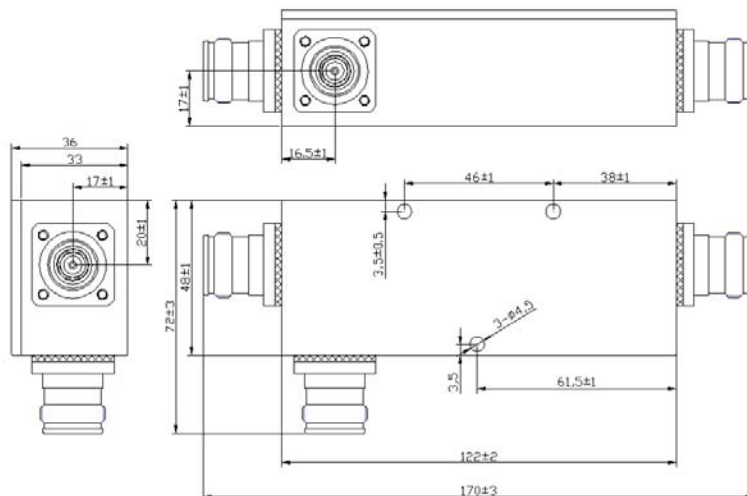

Quoted performance parameters are provided to offer typical, peak or range values only and may vary as a result of normal testing, manufacturing and operational conditions. Extreme operational conditions and/or stress on structural supports is beyond our control. Such conditions may result in damage to this product. Improvements to products may be made without notice.